



ITEM NO: I3210-459-BCK Armoire/ Cupboard

Thank you for purchasing this quality product. Be sure to check all packing material carefully for small parts that may come loose inside the carton during shipment.

WARNING! Before using this product, please read, understand, and follow these instructions. Failure to follow each of these assembly instructions precisely may result in damage to the product and / or injury to the consumer.



UNIT SHOULD BE INSTALLED BY 2 OR MORE PERSONS.



TOOLS REQUIRED (NOT PROVIDED)

PHILLIPS SCREWDRIVER

HARDWARE LIST:

No.	Description	Sketch	Quantity
A	Bolt Ø5/16" x 2"		12 PCS
B	Lock Washer Ø5/16"		12 PCS
C	Flat Washer Ø5/16" x 3/4"		12 PCS
D	Allen Wrench		1 PC

COMPONENTS LIST:

No.	Description	Sketch	Quantity
1	Case		1 PC
2	Bottom Shelf		1 PC
3	Leg		4 PCS
4	Valet Rod		1 PC

FUNCTIONALITY INSTRUCTION

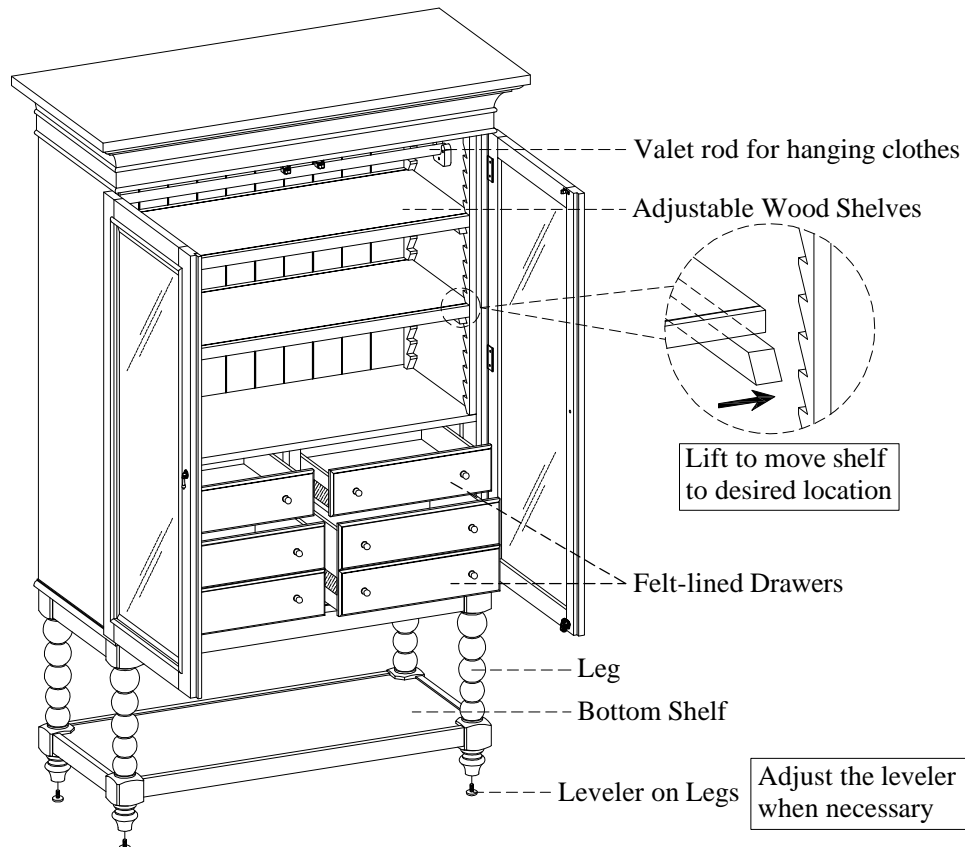

FOR INDOOR USE ONLY



ITEM NO: I3210-459-BCK Armoire/ Cupboard

STEP 1: Put the case backside down on a soft surface.

STEP 2: Attach the legs to the bottom of case by using 8 bolts (A), lock washers (B) and flat washers (C) with an allen wrench (D). Do not tighten bolts completely.

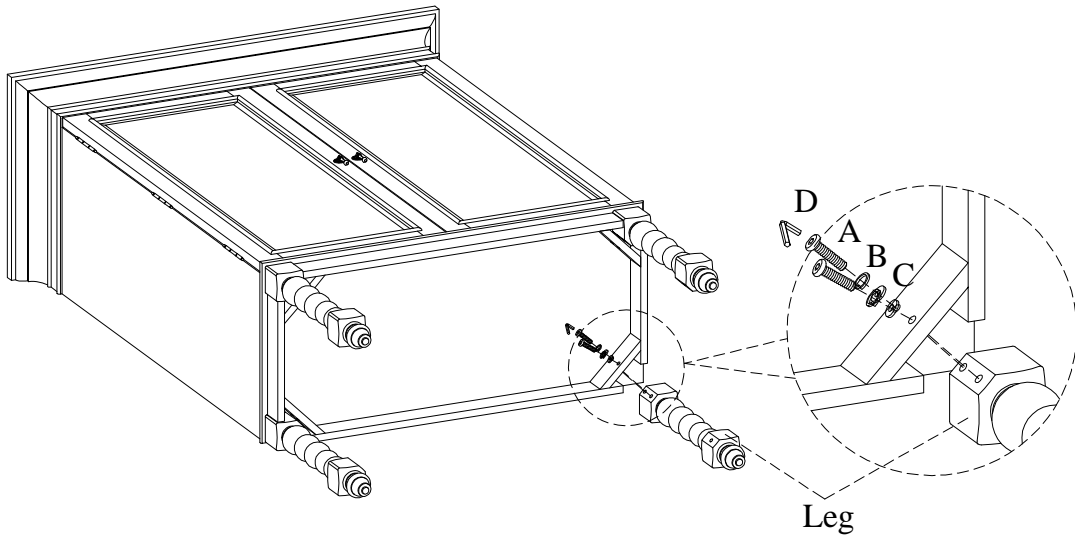

STEP 3: Attach the bottom shelf to legs by using 4 bolts (A), lock washers (B) and flat washers (C). Completely tighten all bolts.

STEP 4: Turn the assembled case to the upright position.

