

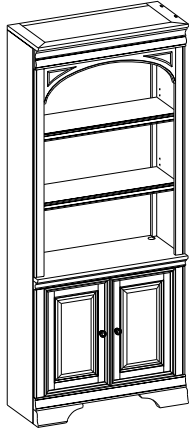

ITEM NO: I92-332 Door Bookcase
I92-333 Open Bookcase

Thank you for purchasing this quality product. Be sure to check all packing material carefully for small parts that may come loose inside the carton during shipment.

I92-332



I92-333

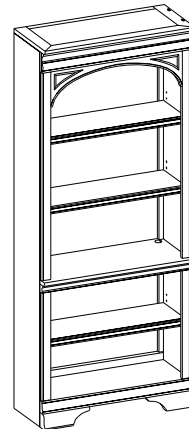

FUNCTIONALITY INSTRUCTION

TOOLS REQUIRED (NOT PROVIDED)

PHILLIPS SCREWDRIVER

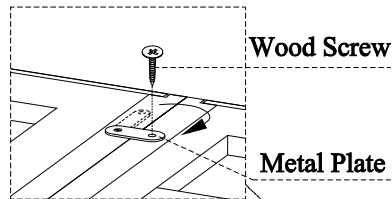

Wood Screw

Metal Plate

Take off one screw from each metal plate and swing it in an ideal place. Line up the front of bookcases then re-secure the metal plate with screw to adjacent bookcase.

Adjustable wood shelf

Adjustable wood shelf

Adjustable wood shelf

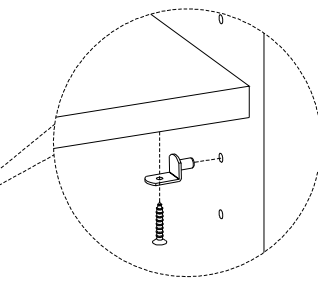

If you prefer to adjust the shelf location, remove the screws and move shelf brackets to the desired location. Then secure the brackets to shelf with screws.

Leveler on base

Adjust the leveler when necessary

BEFORE USING THIS PRODUCT PLEASE READ, UNDERSTAND, AND FOLLOW THESE INSTRUCTIONS. Save these instructions for future reference.

FOR INDOOR USE ONLY



ITEM NO: I92-336 84" Lighted Door Bookcase

Thank you for purchasing this quality product. Be sure to check all packing material carefully for small parts that may come loose inside the carton during shipment.

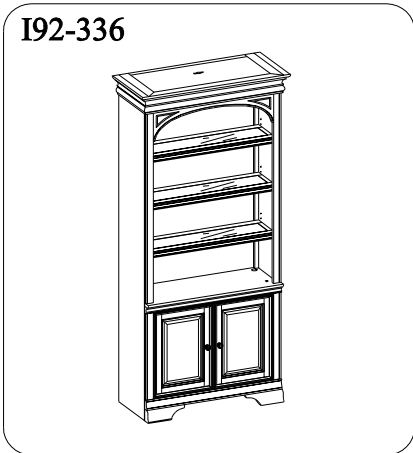

OPTION 1 I92-336 Individual

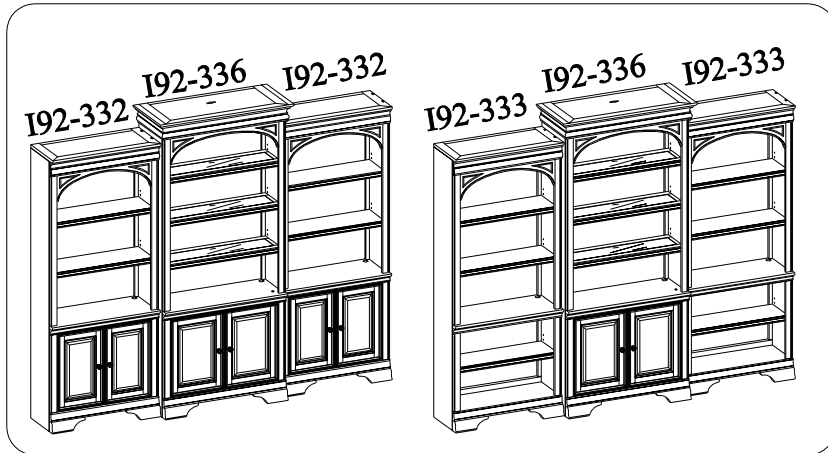

OPTION 2 I92-336 With 332/333 Bookcase

OPTION 1 I92-336 Individual

If you prefer to adjust the shelf location, remove the screws and move shelf brackets to the desired location. Then secure the brackets to shelf with screws.

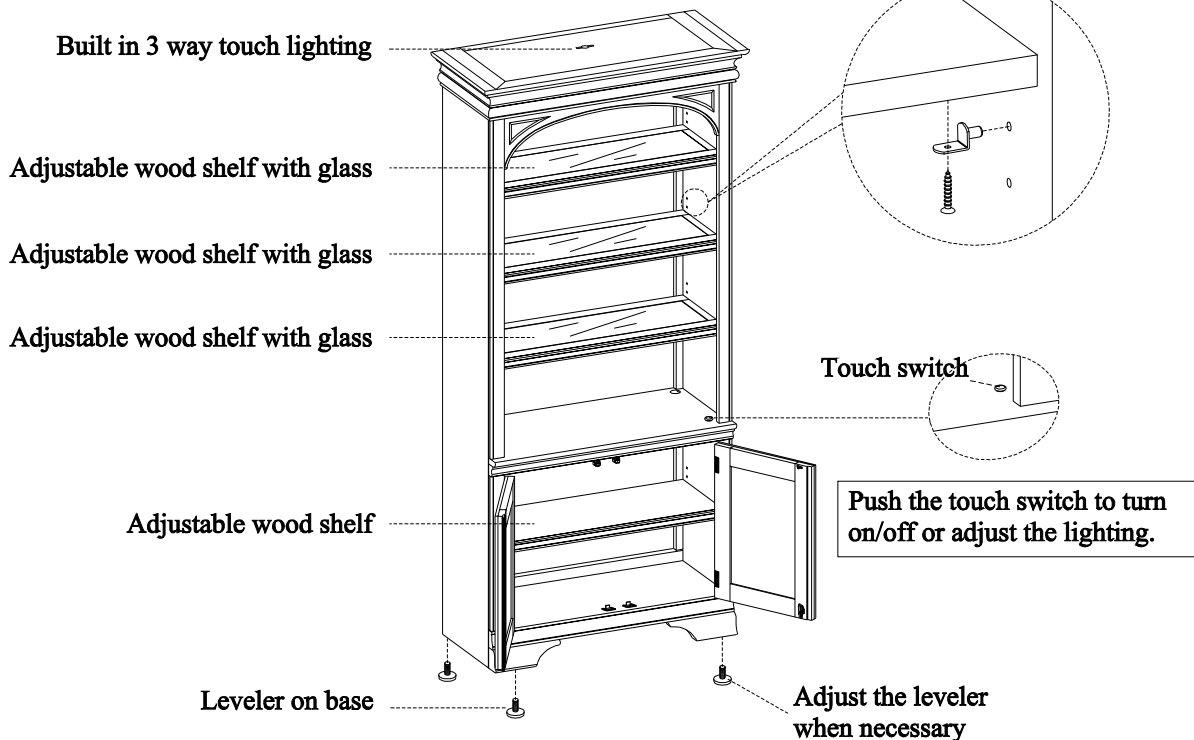

BEFORE USING THIS PRODUCT PLEASE READ, UNDERSTAND, AND FOLLOW THESE INSTRUCTIONS. Save these instructions for future reference.

FOR INDOOR USE ONLY



ITEM NO: I92-336 84" Lighted Door Bookcase

OPTION 2 I92-336 With 332/333 Bookcase

STEP 1: Put the Lighted Door Bookcase in place and put Door/Open bookcase on side. Adjust the leveler when necessary

